

800mm ECX Standard Series Network Cabinet



PRODUCT OVERVIEW

The Enconnex 800mm Standard Series Network Cabinet is the ultimate solution designed and engineered for demanding data center environments. It is perfect for high-density situations where weight is a concern.

- HIGH-DENSITY
- PERFECT FOR DATA CENTERS
- ARRIVE FULLY ASSEMBLED
- FAST ORDER FULFILLMENT

— POWER READY NETWORK RACKS —

All of our network racks and cabinets can be bundled with PDUs to receive big savings and have equipment arrive power ready.

COMPLIANCE/STANDARDS	SPECS
EMC Verification	N/A
Safety Verification	UL2416, CSA C22.2 No. 60950-1
Environmental	RoHS

PRODUCT FEATURES



SOLID STEEL CONSTRUCTION

Solid steel construction provides some of the best load ratings in the industry



MAXIMUM AIRFLOW

High-efficiency perforated doors allow for maximum airflow



EASY ACCESS

Dual side panel design makes accessing the side of your equipment quick and easy



SECURE SOLUTION

Matching locks on the doors and panels for a secure solution that is easy to manage



REDUCED FOOTPRINT

Split rear perforated doors reduces footprint and provides better access to equipment



ACCESSORY OPTIONS

Available airflow and cable management accessories as well as many other options

800MM STANDARD CABINET SCHEMATICS WITH ACCESSORIES

The Enconnex 800mm Standard Series Network Cabinet has many available accessories to add to your build. Take a look below.

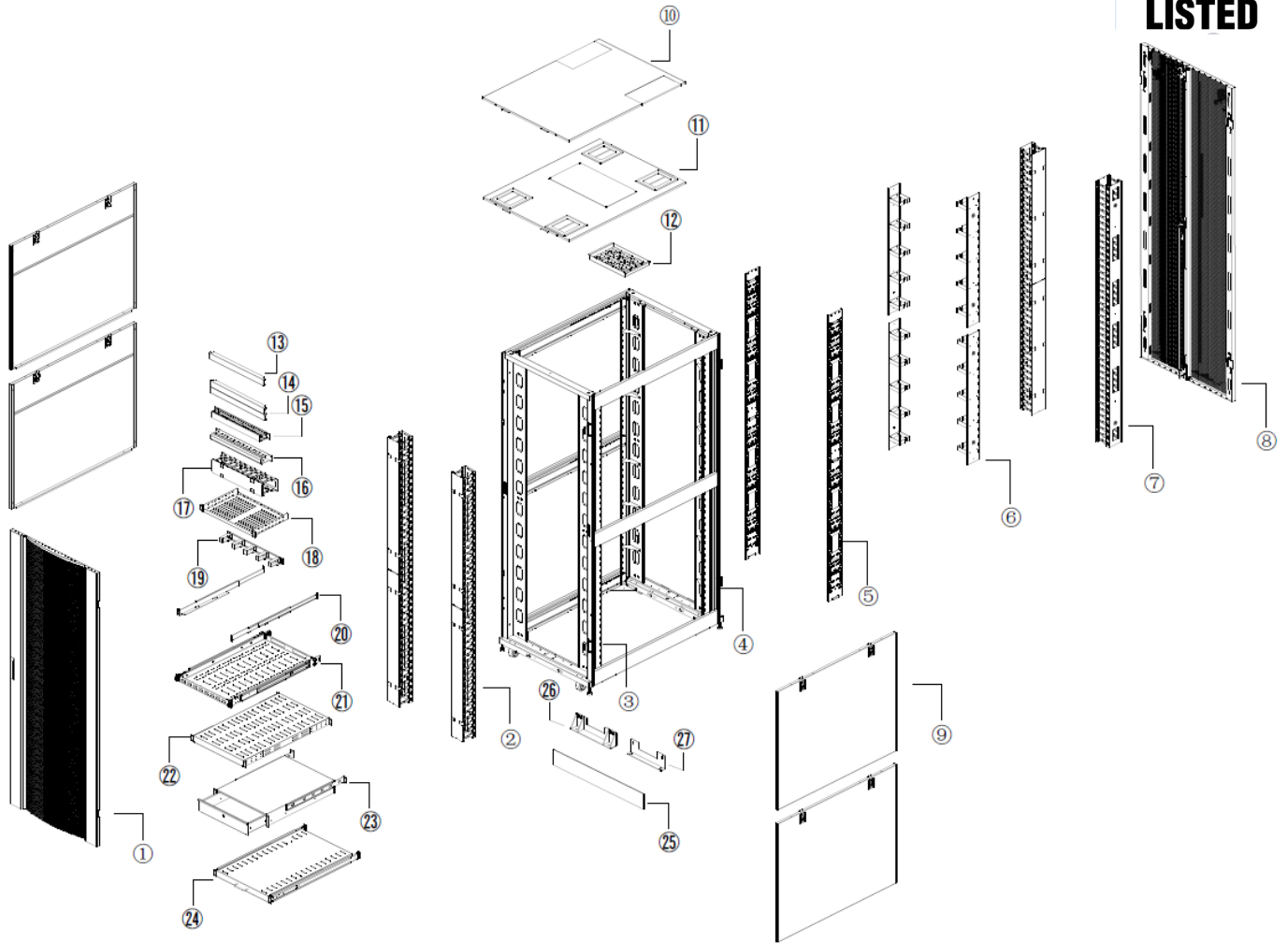

- | | | |
|----------------------------------|--|---|
| 1. Single Front Mesh Door | 10. Roof Panel-Style 2 | 19. 1U Horizontal Cable Management |
| 2. Vertical Cable Management 1 | 11. Roof Panel-Style 1 | 20. 1U Adjustable Mount Shelf Kit |
| 3. Mounting Rail | 12. Roof Fan Tray | 21. 1U Standard Sliding Shelf (No Tool) |
| 4. Rack Frame | 13. 1U Blank Panel | 22. 1U Heavy-Duty Fixed Shelf |
| 5. Adjustable PDU Mounting Rails | 14. 2U Blank Panel | 23. 2u Locking Storage Drawer |
| 6. Cable Manager Loop | 15. 1U Horizontal Plastic Cable Management | 24. 1U Standard Sliding Shelf |
| 7. Vertical Cable Management 2 | 16. 1U Horizontal Metal Cable Management | 25. Vent Skirt Panel |
| 8. Split Rear Mesh Door | 17. 2U Horizontal Plastic Cable Management | 26. Seismic L Bracket |
| 9. Side Panel Split | 18. 1U Cantilever Fixed Shelf | 27. Standard L Bracket |

TECHNICAL SPECIFICATIONS

Basic Frame Constuction	CRS - Corrosion resistance steel and welded components
Space Identification	U-number*44.45
Top Cover	Brush Cutouts for cables and power cords entry
Perforation & Rating	Round Hole - 65%
Mounting Hole Pattern	EIA-310-E Universal Spacing
Standard Color & Finish	Black & Powder coated
Weight Rating (static)	1500 kg (3300 lbs)
Weight Rating (dynamic)	1200 kg (2600 lbs)
Rating	IP 20
Certifications	EIA-310
	UL2416

FEATURES

Front Rail to PDU	899mm (35.39")
Thermal Management	Blanking panels and brush modules
Cable Management	Cable management - Front & Back
Vertical PDU Bars	Assembled with Frame
Rack Handle	Standard Lock,iHandle/ Bump lock optional
Casters & Levellers	3" castor with better obstacle passing ability.
Flame Rating	UL 94, V0
Electrical protection & safety	Grounding & Bonding
Accessories	Baying Kit & Cage Nuts

Model Matrix

PN	Description	W (mm)	D (mm)	H (mm)
ECX-81024-C3	800mm x 1000mm x 24u cabinet w/ side panels, casters, doors and roof	800	1000	24U
ECX-81042-C3	800mm x 1000mm x 42u cabinet w/ side panels, casters, doors and roof	800	1000	42U
ECX-81045-C3	800mm x 1000mm x 45u cabinet w/ side panels, casters, doors and roof	800	1000	45U
ECX-81048-C3	800mm x 1000mm x 48u cabinet w/ side panels, casters, doors and roof	800	1000	48U
ECX-81052-C3	800mm x 1000mm x 52u cabinet w/ side panels, casters, doors and roof	800	1000	52U
ECX-81124-C3	800mm x 1100mm x 24u cabinet w/ side panels, casters, doors and roof	800	1100	24U
ECX-81142-C3	800mm x 1100mm x 42u cabinet w/ side panels, casters, doors and roof	800	1100	42U
ECX-81145-C3	800mm x 1100mm x 45u cabinet w/ side panels, casters, doors and roof	800	1100	45U
ECX-81148-C3	800mm x 1100mm x 48u cabinet w/ side panels, casters, doors and roof	800	1100	48U
ECX-81152-C3	800mm x 1100mm x 52u cabinet w/ side panels, casters, doors and roof	800	1100	52U
ECX-81224-C3	800mm x 1200mm x 24u cabinet w/ side panels, casters, doors and roof	800	1200	24U
ECX-81242-C3	800mm x 1200mm x 42u cabinet w/ side panels, casters, doors and roof	800	1200	42U
ECX-81245-C3	800mm x 1200mm x 45u cabinet w/ side panels, casters, doors and roof	800	1200	45U
ECX-81248-C3	800mm x 1200mm x 48u cabinet w/ side panels, casters, doors and roof	800	1200	48U
ECX-81252-C3	800mm x 1200mm x 52u cabinet w/ side panels, casters, doors and roof	800	1200	52U

PRODUCT CERTIFICATIONS

All Enconnex Series Standard Network Cabinets are UL tested and certified. It is important for our customers to know that our products have been tested to the applicable standards and this provides our products with credibility in the marketplace.