

# 800mm DC Series Cabinets

## Customized Data Center Cabinets at Standard Cabinet Pricing

### PRODUCT OVERVIEW

When you buy the DC Series Cabinet from Enconnex, you get the custom-style cabinet you want, at a standard cabinet price. For datacenter or colocation companies, the DC (datacenter) series server rack is the best value of server racks tailored for data center builds among all the server cabinets on the market. It is 100% designed for data centers- no customization needed, with unique PDU rails, extended server depth allowance, fewer gaps for better airflow management, and built-in cable management--all at 50% less than the competitors.

### BEST VALUE ON THE MARKET.

Buying DC Series Cabinets from Enconnex can save you up to 50%! Ask an Enconnex representative to see a price comparison today.

COMPLIANCE/STANDARDS	SPECS
EMC Verification	N/A
Safety Verification	UL2416, CSA C22.2 No. 60950-1
Environmental	RoHS

### KEY ATTRIBUTES



#### CONVENIENT PDU RAILS

The PDU placement on the side panel, instead of the front, allows for easy server maintenance.



#### INCREASED SERVER DEPTH SPACE

The distance between the front mounting rail to the PDU is 980mm allowing it to fit longer or oversized servers without the extra depth usually required.



#### NO GAPS FOR PREMIUM AIRFLOW MANAGEMENT

Designed to eliminate gaps between the front rail and side panels caused by bent cable radius.



#### BUILT-IN CABLE MANAGEMENT

The cable management slots are specially designed to meet your cable management needs.

## 800MM STANDARD CABINET SCHEMATICS WITH ACCESSORIES

The Enconnex 800mm DC Series Server Cabinet has many available accessories to add to your build. Take a look below.

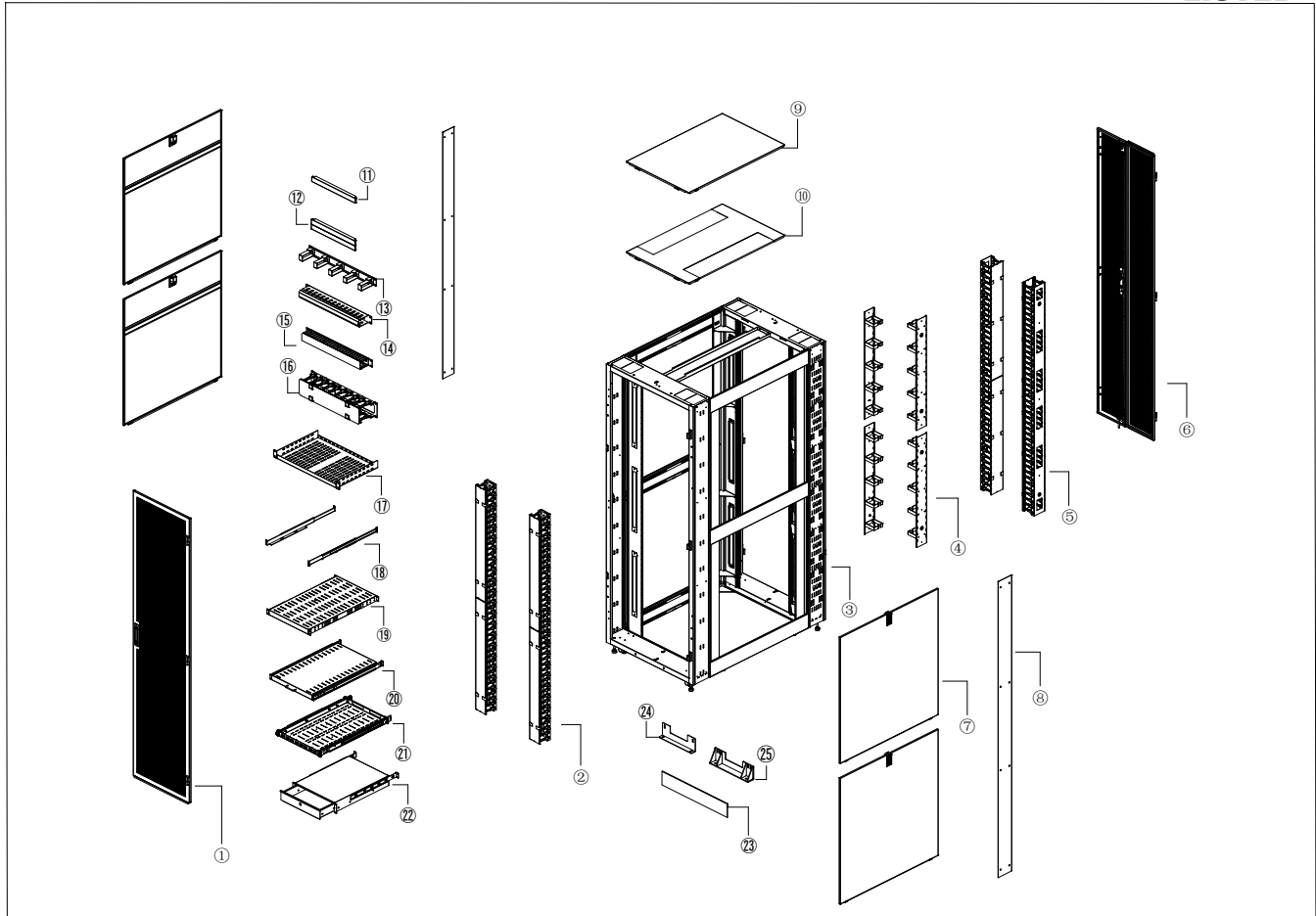

- |                                |  |   |
|--------------------------------|--|---|
| 1. Single Front Mesh Door      | 11. 1U Blank Panel                         | 21. 1U Standard Sliding Shelf (No Tool) |
| 2. Vertical Cable Management 1 | 12. 2U Blank Panel                         | 22. 2U Locking Storage Drawer           |
| 3. Rack Frame                  | 13. 1U Horizontal Metal Cable Management 1 | 23. Vent Skirt Panel                    |
| 4. Cable Manager Loop          | 14. 1U Horizontal Metal Cable Management 2 | 24. Standard L Bracket                  |
| 5. Vertical Cable Management 2 | 15. 1U Horizontal Plastic Cable Management | 25. Seismic L Bracket                   |
| 6. Split Rear Mesh Door        | 16. 2U Horizontal Plastic Cable Management |   |
| 7. Side Panel Split            | 17. 1U Cantilever Fixed Shelf              |   |
| 8. Side Frame Cover            | 18. 1U Adjustable Mount Shelf Kit          |   |
| 9. Roof Panel - Style 2        | 19. 1U Heavy-Duty Fixed Shelf              |   |
| 10. Roof Panel - Style 1       | 20. 1U Standard Sliding Shelf              |   |

## PHYSICAL SPECIFICATIONS

Physical	Specs
Cabinet Dimensions (W x D)	799.6 x 1289 x 2020.5 mm
Cabinet Style	Floor standing
Cabinet Heights	42U, 45U, 48U, and 52U option
Weight Capacity - Stationary	3300 lbs
Weight Capacity - Dynamic	2650 lbs
Casters	3" 1300 lbs load each
UL Rating	60950
RoHS/ELV Compliance	RoHS Compliant, ELV Compliant
NOM	EP Tested for NOM Compliance
Approvals	EIA/ECA-310-E
Colors	Black, white, custom upon request
Units per pallet	1



## SEISMIC SPECIFICATIONS

Standard Cabinet	Our standard cabinet can be configured with a zone 4 mounting kit and bayin kit to meet current Zone 4 compliancy in seismic areas.
Seismic Cabinet	Our seismic cabinets are engineered to meet current GR-63-CORE, NEBS seismic standards. These cabinets are manufactured with a welded design to ensure structural rigity in seismic areas.

Model Matrix					
PN	Description	W (mm)	D (mm)	H (mm)	
ECX-DC-81242-C3	800mm x 1000mm x 24u cabinet w/ side panels, casters, doors and roof	800	1200	42U	
ECX-DC-81245-C3	800mm x 1000mm x 42u cabinet w/ side panels, casters, doors and roof	800	1200	45U	
ECX-DC-81248-C3	800mm x 1000mm x 45u cabinet w/ side panels, casters, doors and roof	800	1200	48U	
ECX-DC-81252-C3	800mm x 1000mm x 48u cabinet w/ side panels, casters, doors and roof	800	1200	52U	

## PRODUCT CERTIFICATIONS

All DC Series Server Cabinets are UL tested and certified. It is important for our customers to know that our products have been tested to the applicable standards and this provides our products with credibility in the marketplace.

